

Appendix 3 BUILDING IDENTIFICATION PLAN

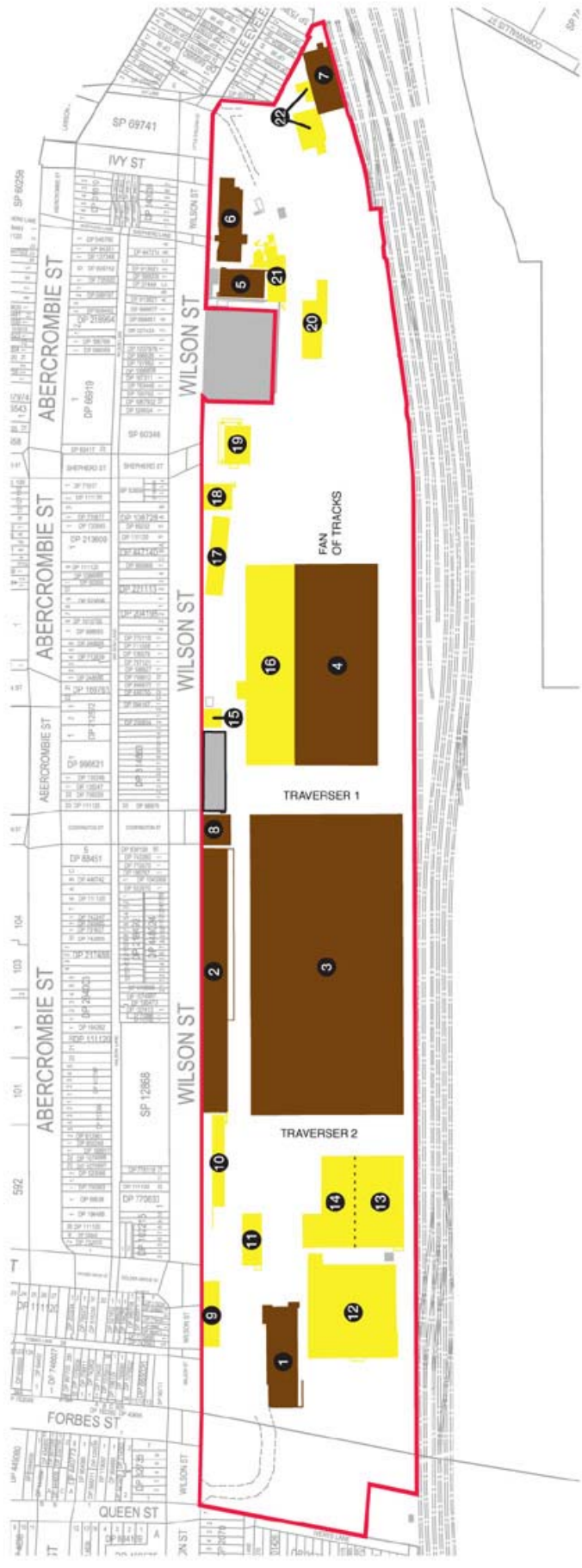

NORTH EVELEIGH - BUILDING IDENTIFICATION PLAN



KEY

BUILDINGS TO BE RETAINED

1. Clothing Store 1913 (also known as General Store) [50]
2. Blacksmith's Shop 1907 [30]
3. Carriage Workshops 1887 [10]
4. Paint Shop 1887 c1912 [12]
5. Scientific Services Building No.1 1916 [59]
6. Chief Mechanical Engineer's Office 1887 [14]
7. Telecommunications Equipment Centre c1912 [31]
8. Pedestrian Entry, Observation Platform and Substation 2006

BUILDINGS TO BE DEMOLISHED

9. Bulk Store c1916 (also known as Spring Store) [48]
10. Reclamation Shed c 1937 [31]
11. Timber Shed extension c 1911 [11a]
12. Stores Buildings from 1883 [5, 6, 6a, 73, 82]
13. Carriage Shop extension 1912 [47]
14. Bollemakers' Shop 1964 [94]
15. Compressor House 1913 [64]
16. Paint Shop addition (also known as the Suburban Car Workshop)

17. RailCorp Emergency Services and Drug and Alcohol unit 1981 [107]
18. Emergency Services Vehicle Shed 1970-1991 [108]
19. Trackfast Depot 1956 [86]
20. Asbestos Removal Building 1970 [84]
21. Scientific Services Building No.2 1966 [83]
22. Outbuildings c1912 and c1970 [31a and 32]

TO BE RETAINED FOR THE IMMEDIATE FUTURE

Yaarna Dhiyaan and Training School 1981 [105]
(also known as Carpenters, Plumbers and Food Distribution building)

Note: [X] refers to building identification numbering including within the Draft Eveleigh Carriageworks Conservation Management Plan (CCP 2020).